

Instruction

EV220B 15-50

Normally Closed/ Normally open (NC/NO)

032R9346

032R9346

Types

- Type EV220B 15, 20, 25, 32, 40, 50 B Normally Closed (NC)
- Type EV220B 15, 20, 25, 32, 40, 50 B Normally Open(NO)
- Type EV220B 15, 20, 25, 32, 40, 50 BD Normally Closed (NC)
- Type EV220B 15, 20, 25, 32, 40, 50 SS Normally Closed (NC)

Media temperature

Gasket materials	Media	Temperature
EPDM	Water / Steam	-30°C → 120°C
NBR	Oil, water and air	-10°C → 90°C
FKM	Oil / inert gas incl air	0°C → 100°C

NC

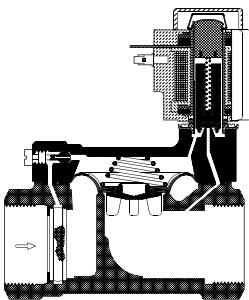

NO

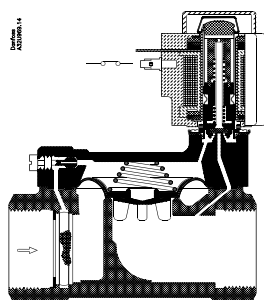

Mounting the valve

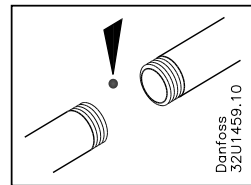

1. Clean the pipe system before mounting the valve

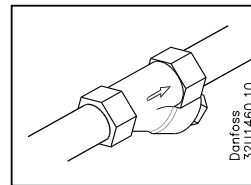

2. Mount filter in front of the valve if there are impurities in media

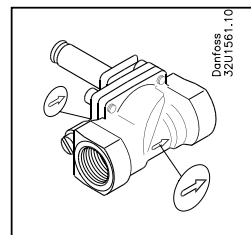

3. The arrow cast on the body and cover must point in the direction of the flow

Coil replacement

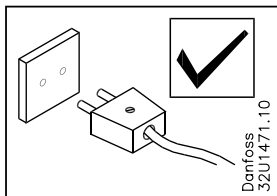

1. Before removing the coil, voltage must be disconnected, otherwise the coil will burn out

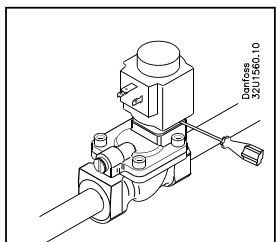

2. Use a screwdriver to lever the coil from the armature.

4. Mount the valve as shown in the pictures. The valve can be mounted with a angle of 360° from upright position.

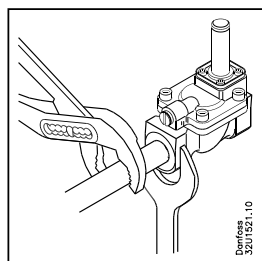
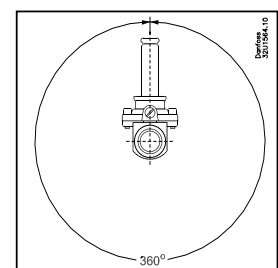
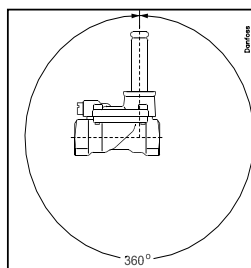

5. Use counterforce when tightening up pipe connections, i.e. use a spanner on both the valve body as well as on the pipe connector.

To be continued on page 2

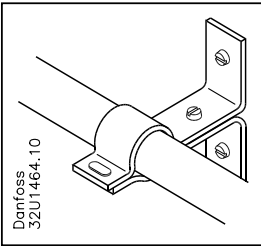

6. The pipes on both sides of the valve must be securely fastened.

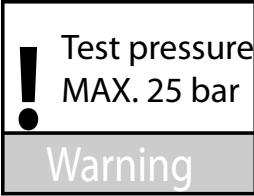

7. Test the system.

Mounting the coil

Note 1. **Warning**
Never switch on power to the coil when the coil is dismantled from the valve. Otherwise the coil may be damaged and there is risk of injuries and burns.

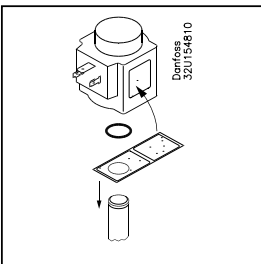

2. Mount the label on the coil and put the armature tube label over the tube.

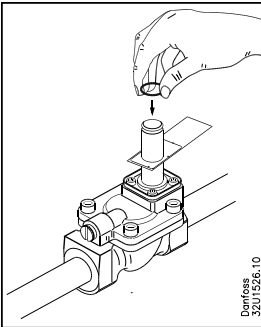

3. Mount the O-ring.

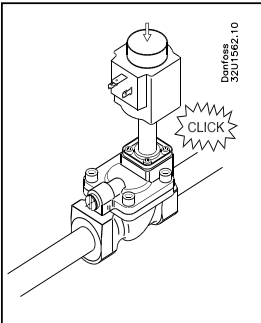

4. Mount the coil on the valve. The coil must **CLICK** in order to be positioned correctly.

Safe working pressure

Types	Pressure
EV220B 15 and 20 (NC/NO) EV220B 25, 32, 40 and 50 (NC/NO)	16 bar

Spare parts kit

Normally Closed valves (NC)

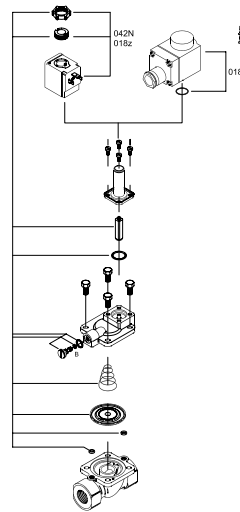

Armature, O-rings, spring, diaphragm

Brass versions		
ValveType	Seal material	Code no.
EV220B 15	EPDM	032U1071
	FKM	032U1072
	NBR	032U6013
EV220B 20	EPDM	032U1073
	FKM	032U1074
	NBR	032U6014
EV220B 25	EPDM	032U1075
	FKM	032U1076
	NBR	032U6015
EV220B 32	EPDM	032U1077
	FKM	032U1078
	NBR	032U6016
EV220B 40	EPDM	032U1079
	FKM	032U1080
	NBR	032U6017
EV220B 50	EPDM	032U1081
	FKM	032U1082
	NBR	032U6018

DZR brass and stainless steel versions		
ValveType	Seal material	Code no.
EV220B 15	EPDM	032U6320¹⁾
	FKM	032U6326
EV220B 20	EPDM	032U6321¹⁾
	FKM	032U6327
EV220B 25	EPDM	032U6322¹⁾
	FKM	032U6328
EV220B 32	EPDM	032U6323¹⁾
	FKM	032U6329
EV220B 40	EPDM	032U6324¹⁾
	FKM	032U6330
EV220B 50	EPDM	032U6325¹⁾
	FKM	032U6331

1) Approved by WRAS

Spare parts kit

Normally open valves (NO)

Valve type	Seal material	Code no.
EV220B 15 - 50	EPDM	032U0296
	FKM	032U0295
	NBR	032U0299

